

**PARTS LIST**  
GROUP II CLIPPERS



INSTRUCTIONS	COL. NO.
106349	BASIC

NEW MODELS ADDED ⇨ FIRST ISSUE	COLUMN #:										
GRAPHITE METALLIC	X										
ELECTRO SILVER		X									
ONE SPEED		X									
TWO SPEED	X										
120 VOLTS, 45 WATTS, AC	X	X									
MODEL OR SERVICE NO. COLUMN →	1	2	3	4	5	6	7	8	9	10	11

INDEX NO.	PART NUMBER	* WAS PART NO.	DESCRIPTION	Basic Parts	QUANTITY REQUIRED															
					078005-140-002	078005-141-002	078005-010-002	078005-011-002	078005-050-002											
1	<a href="#">106942-000-000</a>		SCREW,#6X1/2,TWIN HELIX	2																
2	<a href="#">115286-010-699</a>		COVER-GRAPHITE METALLIC		1															
2	<a href="#">115286-010-599</a>		COVER ELECTRO SILVER			1														
3	<a href="#">113516-032-000</a>		NAMEPLATE, 2 SPD		1															
3	<a href="#">113516-031-000</a>		NAMEPLATE, 1 SPD			1														
5	<a href="#">115544-000-000</a>	109547-000-000	CAPTURE PLATE	1																
6	<a href="#">044946-005-000</a>	044946-000-000	LEVER	1																
7	<a href="#">045515-000-000</a>		LINK	1																
8	<a href="#">041723-000-000</a>		GREASE SEAL	2																
9	<a href="#">111012-010-000</a>	111012-050-000	BRUSH CAP-BLACK	2																
9	<a href="#">111012-070-000</a>	111012-060-000	BRUSH CAP-GRAPHITE				2													
10	<a href="#">042584-025-000</a>	042584-020-000	BRUSH & SPRING ASSY	2																
11	<a href="#">042566-000-000</a>		THRUST PLATE	1																
12	<a href="#">105520-000-000</a>		GEAR (TWO SPEED)		1															
12	<a href="#">058908-000-000</a>		GEAR (SINGLE SPEED)				1													
13	<a href="#">108692-120-005</a>	108783-050-000	HSG-MOTOR-MACH, GRAPHITE METALLIC		1															
13	<a href="#">108692-110-005</a>	108783-060-000	HSG-MOTOR-MACH, ELECTRO SILVER				1													
14	<a href="#">058543-000-000</a>		WASHER-THRUST	1																
15	<a href="#">044941-000-000</a>		HINGE ASSEMBLY	1																
16	<a href="#">109189-000-000</a>		SCREW,#6X,375,PHND	2																
17	<a href="#">045588-000-000</a>		BLADE GUARD	1																
18	<a href="#">111038-050-000</a>		LABEL,DATA,5-14C		1															
18	<a href="#">111038-060-000</a>		LABEL,DATA,5-01L				1													
20	<a href="#">042571-000-000</a>		BLADE GUIDE	1																
22	<a href="#">044936-000-000</a>		SOCKET	1																
25	<a href="#">042555-000-000</a>		BLADE SCREW- #6-32 X 7/32	2																
26	<a href="#">057070-000-000</a>		BEARING	2																
27	<a href="#">042568-000-000</a>		WASHER-FELT	2																
29	<a href="#">058519-000-000</a>		BEARING RETAINER	2																
30	<a href="#">042114-050-000</a>		SCREW	2																
31	<a href="#">042872-000-000</a>		Screw - #6-32 X 1/4	2																
32	<a href="#">084935-000-000</a>		ARMATURE ASSY. - 2 SPEED 120V		1															
32	<a href="#">084934-005-000</a>		ARMATURE ASSY. - 1 SPEED 120V				1													
33	<a href="#">084936-000-000</a>	084936-005-000	FIELD ASSY - 120V		1		1													
34	<a href="#">044938-000-000</a>		LATCH	1																
35	<a href="#">042557-000-000</a>		LOCATING RING	1																
36	<a href="#">042559-000-000</a>		CUP-THRUST SPRING	1																
37	<a href="#">042562-000-000</a>		THRUST SPRING	1																
38	<a href="#">058006-000-000</a>		MOTOR END FRAME ASSY.	1																
42	<a href="#">042570-000-000</a>		RETAINING CUP	1																
44	<a href="#">058172-005-000</a>		SWITCH ASSY-2SPD		1															
44	<a href="#">104365-000-000</a>		SWITCH ASSY-1SPD				1													
45	<a href="#">111013-010-000</a>	111013-050-000	VENT(W/SCREEN) BLACK		2															
45	<a href="#">111013-070-000</a>	111013-060-000	VENT(W/SCREEN) GRAPHITE				2													
46	<a href="#">108780-010-000</a>	108780-050-000	END CAP,TOGGLE, BLACK		1															
46	<a href="#">108780-070-000</a>	108780-060-000	END CAP,TOGGLE, GRAPHITE				1													
47	<a href="#">041756-000-000</a>		LOCKWASHER	2																
48	<a href="#">042574-000-000</a>		SCREW - #6-32 X 1 1/8	2																
49	<a href="#">058168-000-000</a>		SWITCH NUT	1																
50	<a href="#">042614-000-000</a>		BRUSH RETAINER ASSY.	2																
51	<a href="#">042573-000-000</a>		BALE	1																
52	<a href="#">042551-000-000</a>		RETAINING RING	1																
55	<a href="#">110737-000-000</a>		CORD WSR,POLARIZED		1		1													
62	<a href="#">042564-000-000</a>		SCREW- #4-36 X 3/16	2																
74	<a href="#">041680-000-000</a>		GREASE 1 LB																	
75	<a href="#">042113-015-000</a>		SCREW-BT	3																
79	<a href="#">058355-000-000</a>		TERMINAL BRACKET	2																
80	<a href="#">085043-000-000</a>		LABEL, HI-LOW		1															
	<a href="#">041664-000-000</a>		SCREW	1																

SEE PAGE 2A FOR BLADE SET & TENSION SPRING CHART, BLADE ADJUSTMENT SPECS AND BUSHING & RIVET SET INFORMATION.

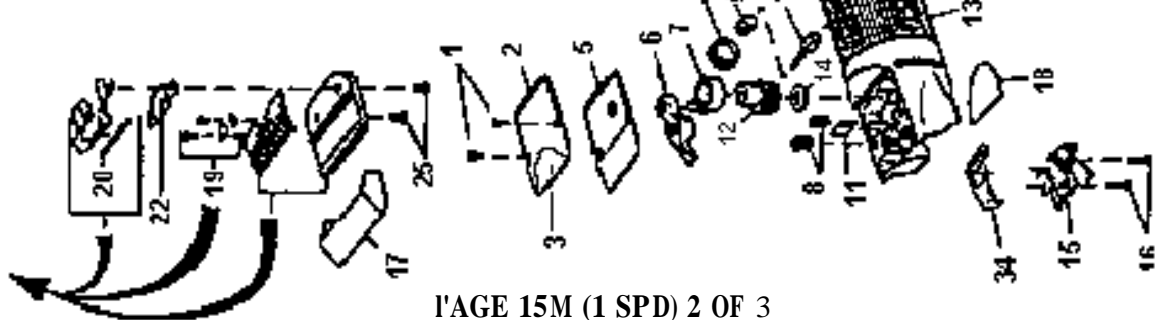

BEFORE ASSEMBLY OF GEAR (12), FILL GEAR STUD WITH GREASE (74). GREASE MUST SQUIRT OUT OF BOTH HOLES IN STUD AND LEAVE STUD FULL OF GREASE. AFTER ASSEMBLY OF GEAR (2) TO STUD, INJECT APPROX. 25g (1/2 oz) OF GREASE (74) BETWEEN GEAR (12) AND THRUST PLATE (11). A PORTION OF THIS GREASE MUST BE ON INTERNAL AREA OF GEAR (12).

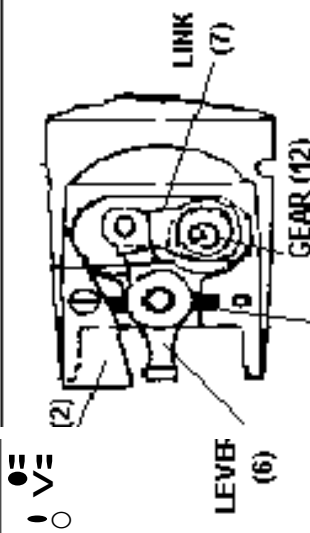

AFTER ASSEMBLY OF LEVER (6) & GREASE SEALS (8), THOROUGHLY SATURATE GREASE SEALS WITH CLIPPER OIL.

CAPTURE PLATE (5) MUST BE ASSEMBLED OVER GEAR STUD, WITH STUD PENETRATING HOLE IN CAPTURE PLATE (5). PLATE COVER (2) IS THEN PLACED ON TOP OF CAPTURE PLATE (5) AND SCREWS (1) DRIVEN TO SECURE.

SATURATE WITH CLIPPER OIL BEFORE ASSEMBLY

END CAP SHOWN ASSEMBLED - FOR REFERENCE ONLY -

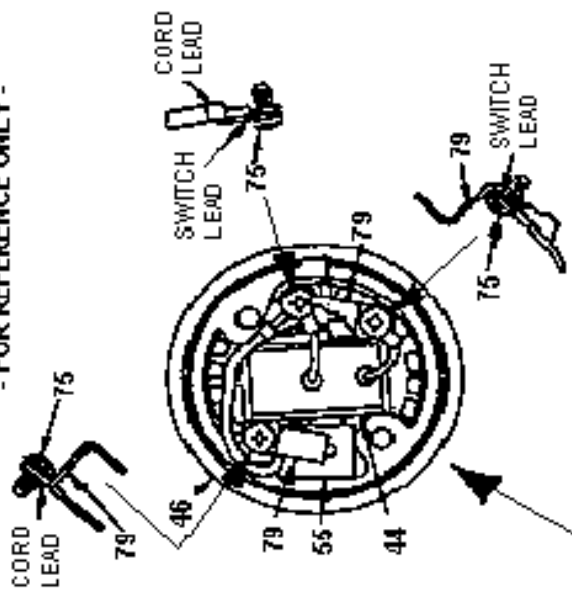

USE NO. 3 TRU-ARC PLIERS OR EQUIVALENT TO REMOVE OR ASSEMBLE RETAINING RING

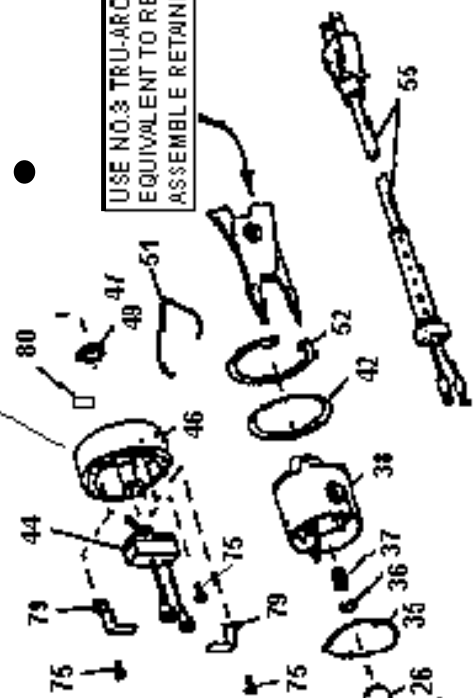

SATURATE WITH CLIPPER OIL BEFORE ASSEMBLY

NOTE: NUMBERS SHOWN ON DRAWING ARE INDEX NUMBERS ONLY. ORDER PARTS BY CORRECT PART NUMBER.

SEE PAGE 2A FOR BLADE SET & TENSION SPRING CHART, BLADE ADJUSTMENT SPECS AND BUSHING & RIVET SET INFORMATION.

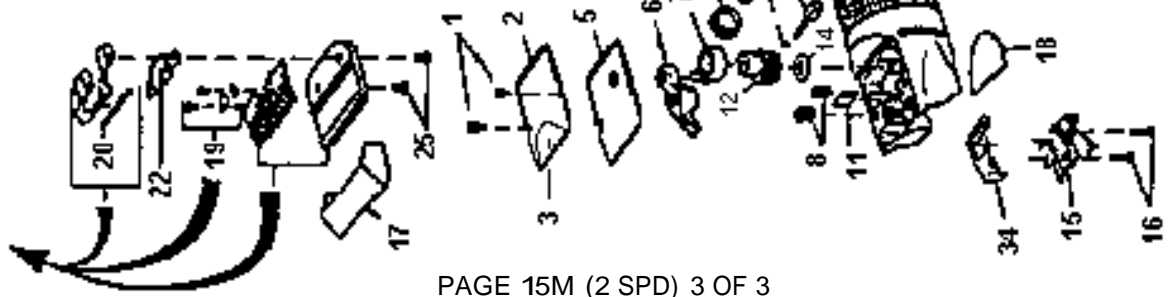

BEFORE ASSY OF GEAR (12), FILL GEAR STUD WITH GREASE (74). GREASE MUST SQUIRT OUT OF BOTH HOLES IN STUD AND LEAVE STUD FULL OF GREASE. AFTER ASSY. OF GEAR (- 2) TO STUD, INJECT APPROX. 25g (1/2 oz) OF GREASE (74) BETWEEN GEAR (12) AND THRUST PLATE (11). A PORTION OF THIS GREASE MUST BE ON CAM AREA OF GEAR (12).

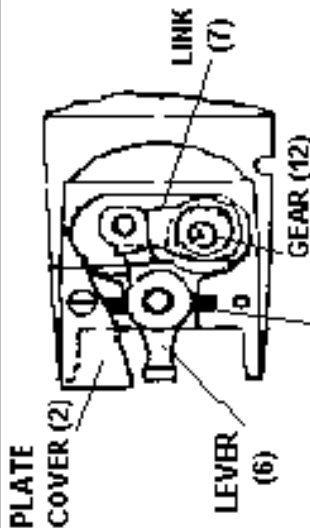

AFTER ASSEMBLY OF LEVER (6) & GREASE SEALS (8), THOROUGHLY SATURATE GREASE SEALS WITH CLIPPER OIL.

CAPTURE PLATE (5), MUST BE ASSEMBLED OVER GEAR STUD, WITH STUD PENETRATING HOLE IN CAPTURE PLATE (5). PLATE COVER (2) IS THEN PLACED ON TOP OF CAPTURE PLATE (5) AND SCREWS (1) DRIVEN TO SECURE.

SATURATE WITH CLIPPER OIL BEFORE ASSEMBLY

**END CAP SHOWN ASSEMBLED**  
- FOR REFERENCE ONLY -

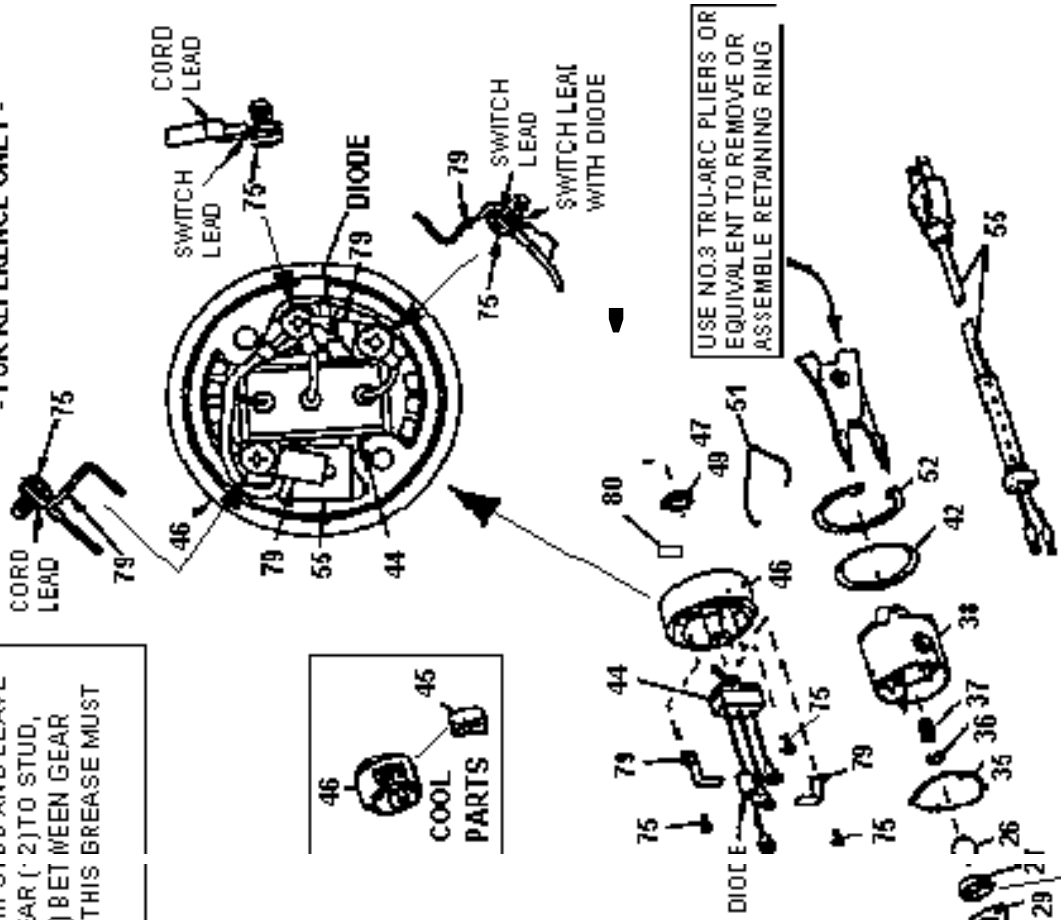

USE NO.3 TRU-ARC PLIERS OR EQUIVALENT TO REMOVE OR ASSEMBLE RETAINING RING

SATURATE WITH CLIPPER OIL BEFORE ASSEMBLY

NOTE: NUMBERS SHOWN ON DRAWING ARE INDEX NUMBERS ONLY. ORDER PARTS BY CORRECT PART NUMBER.